

Thank you very much for purchasing Magne Charger. Please read this user manual carefully in order to ensure the correct use of this appliance. Please save this manual in a safe place for future reference.

Important! Please read carefully before using this appliance.

- Please be sure to set aside tap water in order to avoid the use of Drinking water in the case of an emergency.
※We recommend keeping a stock of 2ℓ of tap water or emergency drinking water close to its expiration date. ※When using four rods of Magnesium.
- Although this product can be stored in an unused or unopened state for more than 10 years, please avoid storing in a hot and humid environment as it may become unusable.
- The warranty will not be valid if the appliance is stored or opened in a poor environment.
- USB Charging is possible only in DCP mode. Fast charging can not be used with this appliance alone.
※DCP mode is an abbreviation of Dedicated Charging Port and is a USB port intended for charging purposes only. You can charge up to 500 mA with this appliance.
- Smartphones that support only fast charge can not be charged with this device. You can charge a commercially available mobile battery first with this appliance, then charge the smartphone with the mobile battery.
- In the case of an emergency, sea water or urine can be used instead. However, since these contain contaminants, the power generation level will be lower than usual than with salt water, and USB charging will not be possible.
- Depending on the smart phone model or USB functions, charging may not be possible with some devices .
- Charging is not possible in an environment that would cause salt water to freeze.
- This product has a water resistance rating of IPX 6 and is protected from water splashes. Never submerge this device in water.
- Although the magnesium hydroxide produced by electricity generation is harmless, please dispose of it as burnable garbage as it may clog the water pipe if thrown into the sink. Salt water may be poured down the drain as is with no problems.

Important Safety Information

Please be sure to follow the instructions for your safety.

The precautions shown here are to ensure users use this appliance safely and correctly in order to prevent injury to themselves or others and/or property damage. The magnitude and urgency of possible harm or damage are classified into two categories, "warning" and "caution". As both are important instructions concerning safety, please be sure to follow them.

Warning

Ignoring this instruction and handling the appliance incorrectly may lead to serious injury or even death.

Caution

Ignoring these instructions and handling the appliance incorrectly may lead to injury.

Meanings of each symbol

This symbol indicates prohibited acts. Sepcific details are written next to it.

Ex: Pictogram indicating "disassembling is prohibited."

This symbol indicates that it is something that must be done. Sepcific details are written next to it.

Ex: Pictogram indicating "unplug the cord."

Warning

- If smoke, overheating, unusual odor, or abnormal noise occurs during use, unplug the connected equipment, discard the salt water and stop using the appliance. It may cause fire and/or electric shock.
- Avoid any strong impacts to the device such as dropping or swinging it around as it may result in injury or electric shock or cause the device to catch fire.
- Never attempt process or disassemble/remodel this appliance or the Magnesium. It may result in injury, or electric shock or start a fire.
- Avoid storing or using this appliance in hot and humid environments, under direct sunlight, or near fire. It may cause the device to catch fire.
- Do not look into the area that is emitting light while it is turned on as there is a possibility that vision deterioration and/or injury may occur in the eyes.
- The appliance should not be used by children on their own or placed where infants can reach.
- Never put the salt water poured into the device, reactants, or Magnesium into your mouth.
- For families with small children or pets, be careful not to let them accidentally swallow the reactants. In the event that your child or pet swallows the reactants, consult your doctor immediately.
- In case the reactants should get in your eyes or on your skin, rinse it and consult your doctor immediately.

Caution

- Only use this appliance on flat surfaces in order to prevent it from falling.
- If the rubber lid of the USB port is open, the appliance will no longer be water resistant. When there is a chance it will get wet, be sure to close the rubber lid.
- Be careful not to let salt water stick to the USB cable during USB charging.
- Do not use benzene, diluting solution, detergent, etc. for cleaning. Simply wipe with a dry cloth.
- Although bubbles may come out from the rubber stopper section, it is not a malfunction. Simply wipe it with a tissue etc.
- If the surrounding temperature is below the freezing point, add salt to prevent freezing.
- In the event that you don't use the appliance for charging for more than 24 hours, discard the salt water and reactants into the tank, then clean and dry it before storing it.

Descriptions of Individual Parts

Top: Lid

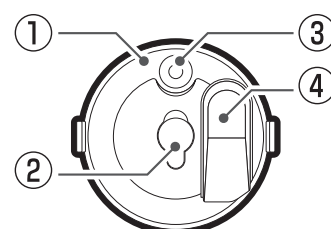

Top: Inside the tank

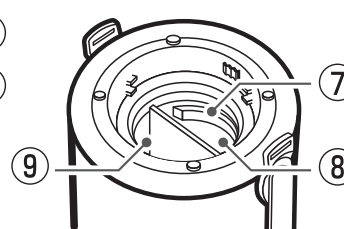

Front

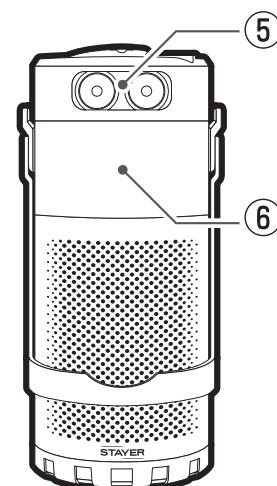

Back

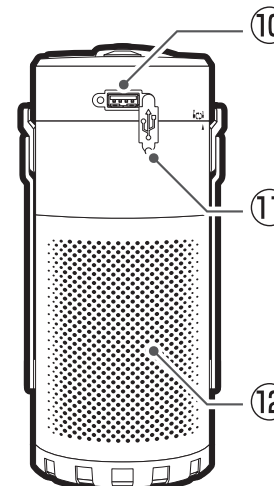

Side

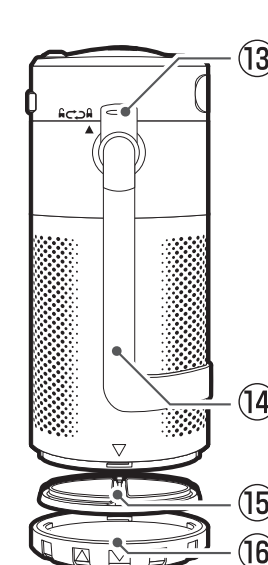

Accessories

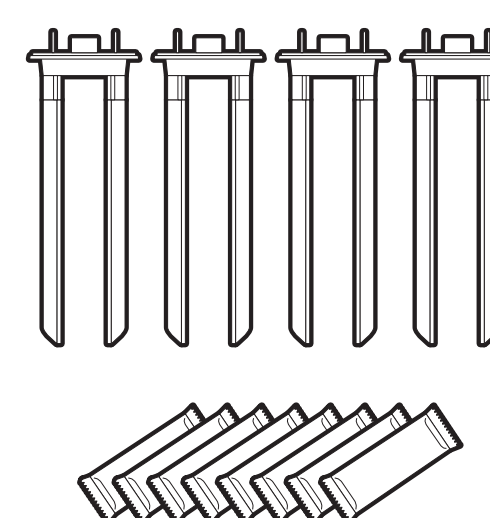

Magnesium: 4 rods

Salt: 8 bags

Q&A

LED won't light, or it is dark.	·Is the amount of water and salt adequate? ·Is the Magnesium used up? As time goes by, it will deplete and become dim. ·Make sure the Magnesium and the lid are properly set. The light may be dark due to insufficient contact. ·Has some time gone by since salt water was added? Please change the salt water and try again. ·Did you use tap water? drinks, seawater, urine, etc. may affect the lighting intensity. ·Press the LED switch firmly several times. There may be a case of contact failure or the device may be turned off.
USB device won't charge.	·All charging is done in DCP mode. Charging may not be possible depending on the model of the smartphone. ·Depending on the state of the smartphone, it may not get 100% charged. ·Make sure the Magnesium and lid are properly set. ·Use only the proper USB cable that came with the device that you want to charge. ·Smartphones that support only fast charge cannot be charged. Charge a commercially available mobile battery first with this appliance, then charge the smartphone with the mobile battery. ·Is the amount of water and salt appropriate? Each tank requires a specified amount of water and salt. For details, please refer to the ①Preparation section of this user manual. ·Turn off the lighting when charging a device that needs electric current such as smartphones. ·If charging is not possible at low temperatures, try adding a tablespoon of salt to Tank 1 and Tank 2 respectively. However, if salt is added, the time of power generation will decrease.
Water leaks.	·Ensure that the lid, bottom cover and bottom cover gasket are tightly closed. ·If there is too much water, water may leak. ※ The appropriate water level is under the water pouring gauge in the tank. ·Although bubbles may come out from the rubber stopper section, it is not a malfunction. Please wipe it with a tissue etc.
What should I do after I've finished using the appliance?	·Discard the reactant (magnesium hydroxide) as burnable garbage, and Magnesium as unburnable. For details, refer to the ③Drainage / maintenance method section of this user manual.
If the Magnesium is opened, but unused, can I store it for a long time?	·If the Magnesium is opened, try to use it up as soon as you can. Please note that once it's opened, the warrantly will no longer be valid.

Specifications

Brightness	Front light High 130 lm / Low 70 lm, Lantern light 100 lm
Total power generation	35Wh/1rods × 4 rods = 140Wh
Output voltage · electric current	DC4.5V～5.4V/200～500mA
Water filling amount	180 ml × 2 Total 360 ml
Salt Amount Required	15g × 2 Total 30g 【Including 4g of citric acid per bag in enclosed salt bags】
USB	1 port, DCP mode
Water Resistance Rating	IPX 6
Size	Height 206.5 mm Diameter 86 mm
Weight	About 415 g (before pouring water) About 775 g (after pouring water)
Operating temperature	-5℃～45℃
Accessories	Magnesium: 4 rods / Salt: 8 bags / User Manual / Warranty

- ※ Usage time is an estimate only. Time may differ based on usage or situation/environment.
- ※ Product specifications and appearance may be changed for improvement without notice.
- ※ USB cable is NOT an included accessory.

Specifications

Usage amount per Magnesium

USB charging	About 6,300 mAh (3.6 V)
LED lighting	About 24 hours or longer (with lantern light)

※Usage time and times of use are only an estimate. The actual usage time and times of use depend on the usage environment.
※When using water other than tap water, there will be less power generation.

Specifications of Salt (per bag)

Salt / citric acid	15g/4g
--------------------	--------

※Including the use of citric acid increases the precipitation of the water content produced after power generation, which makes maintenance easier. As there is no influence to the power generation itself, salt can be used alone as well.

Specifications of Magnesium

Material	Magnesium
----------	-----------

Inquiries / Repair Requests

STAYER Holdings Inc.

【Consumer Care Center】 Japanese only

 **0570-020-511**

(Weekdays 10:00～12:00 / 13:00～17:00)

<http://www.stayer.co.jp>

support@stayer.co.jp

TR Building 6F 3-2-2 Yotsuya, Shinjyuku-ku,
Tokyo 160-0004

【Optional】

Magnesium
cartridge (2 sets)

Model number:
SH-GDMC-M2

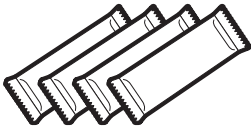

Salt: 4 bags

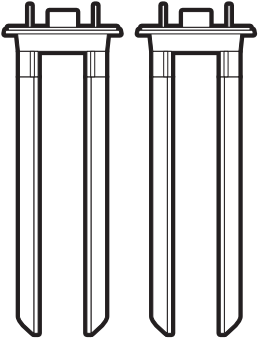

Magnesium: 2 rods

STAYER Warranty

Product name	Magne Charger	Model number	SH-GDMC-MB
Customer	Name		
	Address 〒 -		
	Phone number () -		
Date of purchase Year / Month / Day		Store name	
Period of warranty (from the date of purchase) One year for main appliance Excludes expendable parts			

- This appliance is under a warranty for a period of one year after the date of purchase. During this period, if any defect should appear, in the event that you have followed all instructions on the user manual, we will repair the product at our own expense. Send the product to our repair team with this warranty, or bring the product and receipt to the shop where you purchased it, and we will pay for repair. Transportation costs, shipping fees and other related costs will be at the customer's expense. In addition, you may incur some fees for tranportation costs of materials between our company and shops or other expenses.
- Even during the warranty period, the repair will NOT be free of charge in the following cases.
(1) If a defect or damage is due to careless handling, misuse, or abuse.
(2) If a defect is caused by improper repair, remodeling, disassembling, cleaning, or abnormal voltage.
(3) If a defect or damage is due to a natural disaster such as fire, earthquake, or flood.
(4) If a defect is caused by inadequacy in storage and/or inadequate care.
(5) In the case where no warranty is presented or when required information (purchase date, store name) are not filled in.
(6) This warranty is only valid in Japan.
- We do not reissue the warranty card, so please hold on to it in a safe place.
- Please contact us for any questions regarding any items mentioned in this warranty.

STAYER Holdings Inc.

 **0570-020-511**

(Weekdays 10:00～12:00 / 13:00～17:00)

<http://www.stayer.co.jp> support@stayer.co.jp

Caution

Although we can directly handle customer's questions regarding appliance usage specifications, and requests for repairs not under warranty , requests for returning, exchanging, and repairs covered by warranty are only available through the official retail stores during the warranty period. If you wish to make use of these servies, please contact the store where you purchased the product.

1 Preparation

⚠ Caution

•Air is suctioned through the vent hole. Do not block it or spill water on it. •The interior is divided into two separate tanks and it is not possible to charge smartphones unless the specified amount of water and salt are inserted into each tank (tank 1 / tank 2)

- 1 Rotate the lid counterclockwise to unlock the appliance, lift it up and remove it.

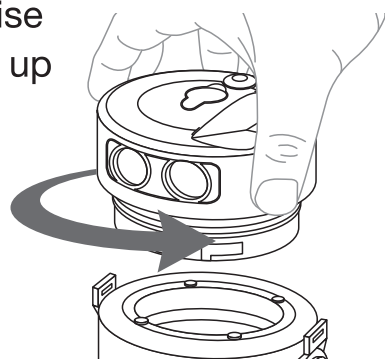
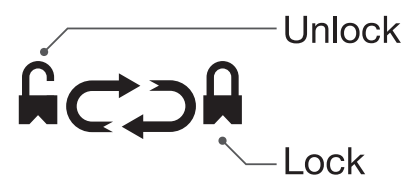

- 2 Measure the salt. Put salt in the salt measuring scoop and top it off to measure 15g.

※When pouring salt into the tank, please be sure to avoid the salt to be attached on the terminals or any metallic parts of Magne Charger, in order to avoid lusting.



Exactly 15g of salt is in the included salt bags, so measuring is not necessary.



- 3 Put 15g of salt each in Tank 1 and Tank 2.

※Please make sure to pour sufficient amount of salt in both tank 1 & tank2. If the amount of salt is insufficient, the ability of power generation will decline.

※In case pouring the salt directly from the lid is difficult, place the salt onto paper first, then pour the salt into the tank1and2.

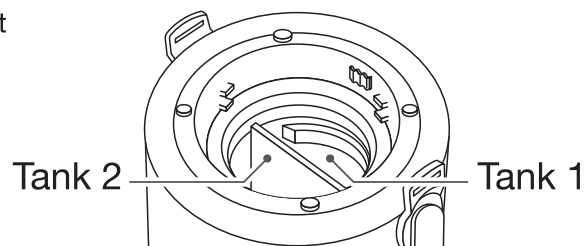

- 4 Pour water into both Tank 1 and Tank 2 up to the red fill auge on the bottom side of the tank.

※Too much water will cause water leakage. Ensure that it is below the fill gauge.

※Tank 1 and Tank 2 are not connected and are completely separate tanks. Put the same amount of water in each tank.

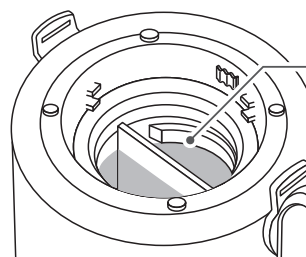

Do not exceed the fill gauge.



In the case of an emergency, sea water or urine can be used instead. However, since these contain contaminants, the power generation level will be lower than usual than with salt water, and USB charging will not be possible.

- 5 Align the female socket of the Magnesium with the male socket of the appliance, and insert Magnesium into the tank.

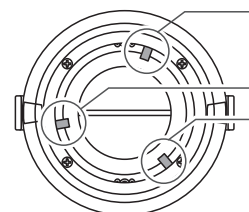

The male socket of the appliance

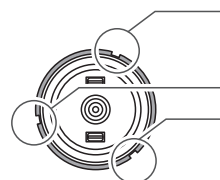

The female socket of the Magnesium

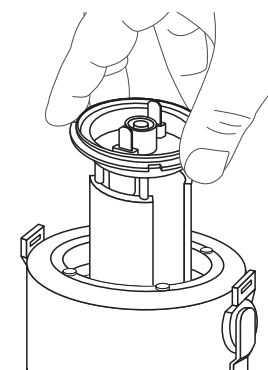

- 6 Align mark on the side of the lid with mark on the body. Rotate the lid clockwise until align with .

※Make sure the lid is sealed well to avoid leakage.

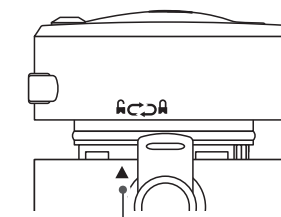

Align with mark

Rotate the lid clockwise until align with .

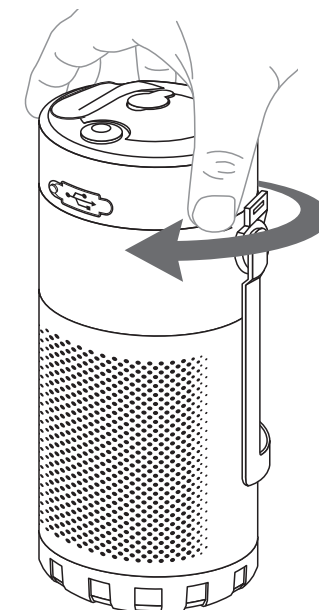
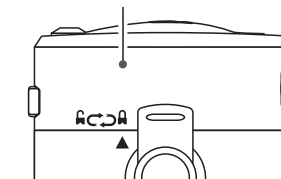

- 7 Open the rubber stopper on the lid.



Since chemical reaction occurs inside the tank and gas (harmless) is generated, be sure to open it the rubber stopper.

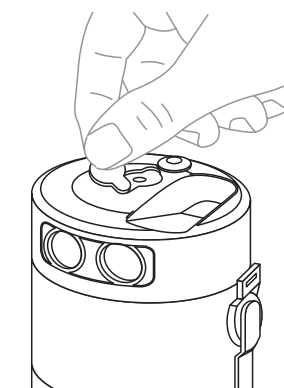

Regarding the timing of exchanging Magnesium and salt water

•When the lighting becomes weak or USB charging becomes impossible, exchange Magnesium and salt water.

※Because USB charging requires more power than lighting, charging may be impossible even when the light is still working.

•If you do not use the appliance for 24 hours, drain the salt water and wash the appliance.

※Magnesium cartridge (2 sets) are sold separately

2 How to Use

⚠ Caution

•After filling appliance with water, it may take 15 minutes or more to reach the necessary power to charge devices. •Charging up to 100% may not be possible depending on the state of the smartphone. •All charging is done in DCP mode. Depending on the device, charging may not be possible. •Use the proper USB cable of the smartphone you intend to charge. •Be careful not to get the appliance wet with water while charging. •Smartphones that support only fast charge can not be charged. Charge a commercially available mobile battery first with this appliance, and charge the smartphone with the mobile battery. •If charging is not possible at low temperature, try adding a tablespoon of salt to Tank 1 and Tank 2 respectively. However, if salt is added, the time of power generation will decrease. •When using the light and charging at the same time, charging may not be possible depending on the device. Turn off the light and charge the battery, or use a mobile battery. •While in use, Magnesium charger will become around 40°C(104°F). In order to avoid low temperature burn, please be cautious when touching the product directly with your skin for long period of time.

How to Use the Light

1

After everything is ready (see [Preparation] on the back side), press the LED switch.

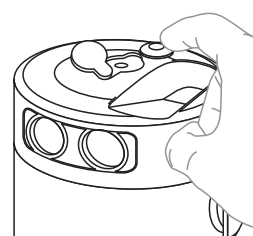

2

There are 3 kinds of lighting - front light (weak), front light (strong), lantern light. The mode changes each time the button is pressed.



We recommend turning off the lighting when charging a device that needs charging current such as smartphones.

1

After everything is ready (see [Preparation] on the back side), you can start charging a device by connecting its USB cord to the appliance.

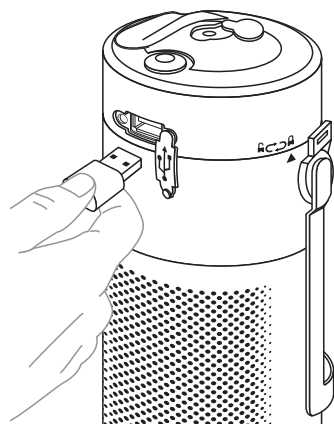

USB charging may not be possible with the light on.

*Charging is possible irrespective of LED switch.

*Use the proper USB cable of the device you intend to charge.

How to charge a USB device (smartphones, etc.)

⚠ Caution

•Ensure to wash the appliance immediately after usage. Otherwise it may cause malfunction. •Dispose of used Magnesium as unburnable garbage. •The reactants produced by electricity generation are harmless magnesium hydroxide, but discard them as burnable garbage as they may clog the drain. However, the salt water may be poured down the drain with no problems. •Drain the water in a place where no problems will arise if you spill. •If you want to temporarily stop using the appliance, we recommend that you remove the Magnesium from the main body. •In the case that you don't use the appliance for charging for more than 24 hours, discard the salt water and reactants in the tank, then clean and dry it before storing.

3 Draining / Maintenance

1

Rotate the lid counterclockwise to unlock it, lift it up and remove it.

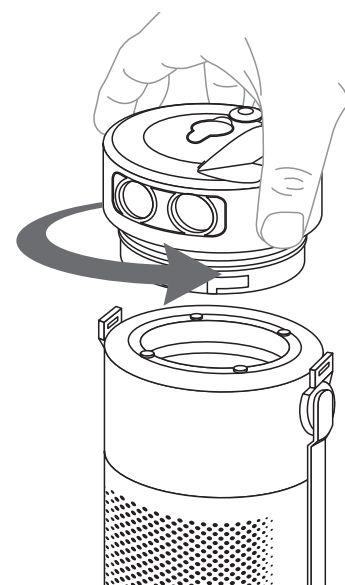

2

Remove the used Magnesium from the tank.

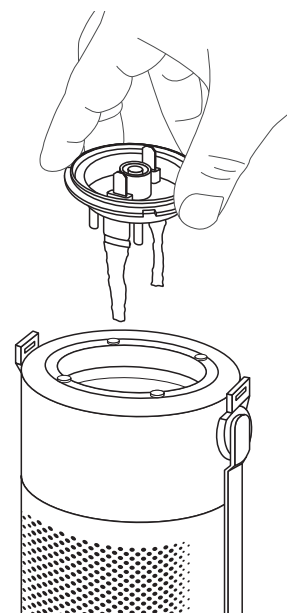

3

Open the bottom cover, pinch the bottom cover gasket and remove it. Remove the reactants of Magnesium and salt water accumulated in the tank.

*Discard the reactants as garbage.

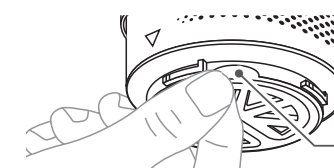
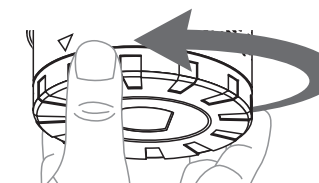

Where to pinch

4

If you wish to continue to use the appliance

Remove all reactants of Magnesium and salt water, gently wipe the appliance and metal parts, and use it as it is.

When storing

Rinse it with water and clean the interior carefully. To prevent it from rusting, wipe the appliance and completely dry it and all metal parts before storing.

*Dry used Magnesium before storing it.



Never use toothbrush or other equipment to wash the inside of the appliance as it may cause a malfunction.

5

After installing the bottom cover gasket, match the ▽ mark of the appliance and the ▽ mark of the bottom cover, rotate the bottom cover counterclockwise, then turn it to the △ mark on the appliance to lock it.

Match the ▽ mark of the bottom cover

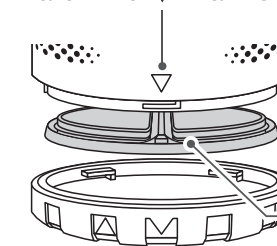

Bottom cover gasket

Rotate it to the position of ▽ mark.

